

WOOD SQUARE

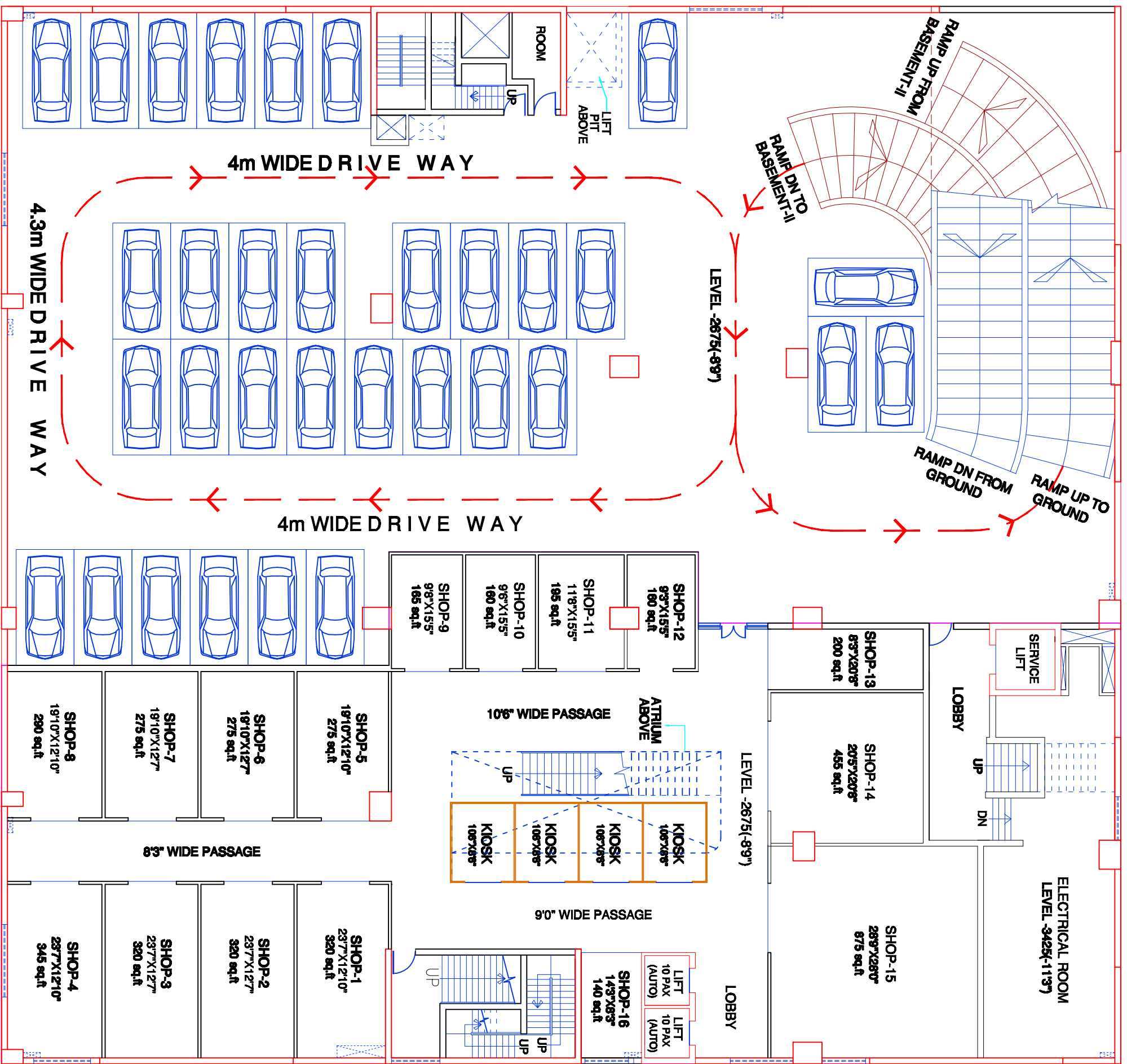

PROJECT :-

COMMERCIAL AT NARENDRAPUR, KOLKATA.

DATE- 26.05.10

ARCHITECTS

SCALE - 1 : 175

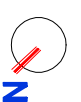

AGRAWAL & AGRAWAL
 BARODA KOLKATA

UPPER BASEMENT
 TOTAL FLOOR AREA: 21399.22 sq.ft
 COMMON AREA :4025 sq.ft
 (INCLU. LIFT CUT OUTS)
 TOTAL PARKING AREA: 12211.94 sq.ft
 CAR PARKING = 32 NOS.